



KAINDL



# AQUA pro



SUPREME | SELECT by KAINDL

A NEW GENERATION  
**OF WATER RESISTANCE.**



# SUPREME



**K4440** Historic Oak EARTH HB



**K4441** Historic Oak SAMOA HB



**K4442** Historic Oak ARCTIC HB



**K5845** Epic Oak APULIEN HB



**K4441** Historic Oak SAMOA HB Historic Bevel



**35991** Concrete **FOSSIL** AV Wire Brushed

# Product Construction Supreme & Select

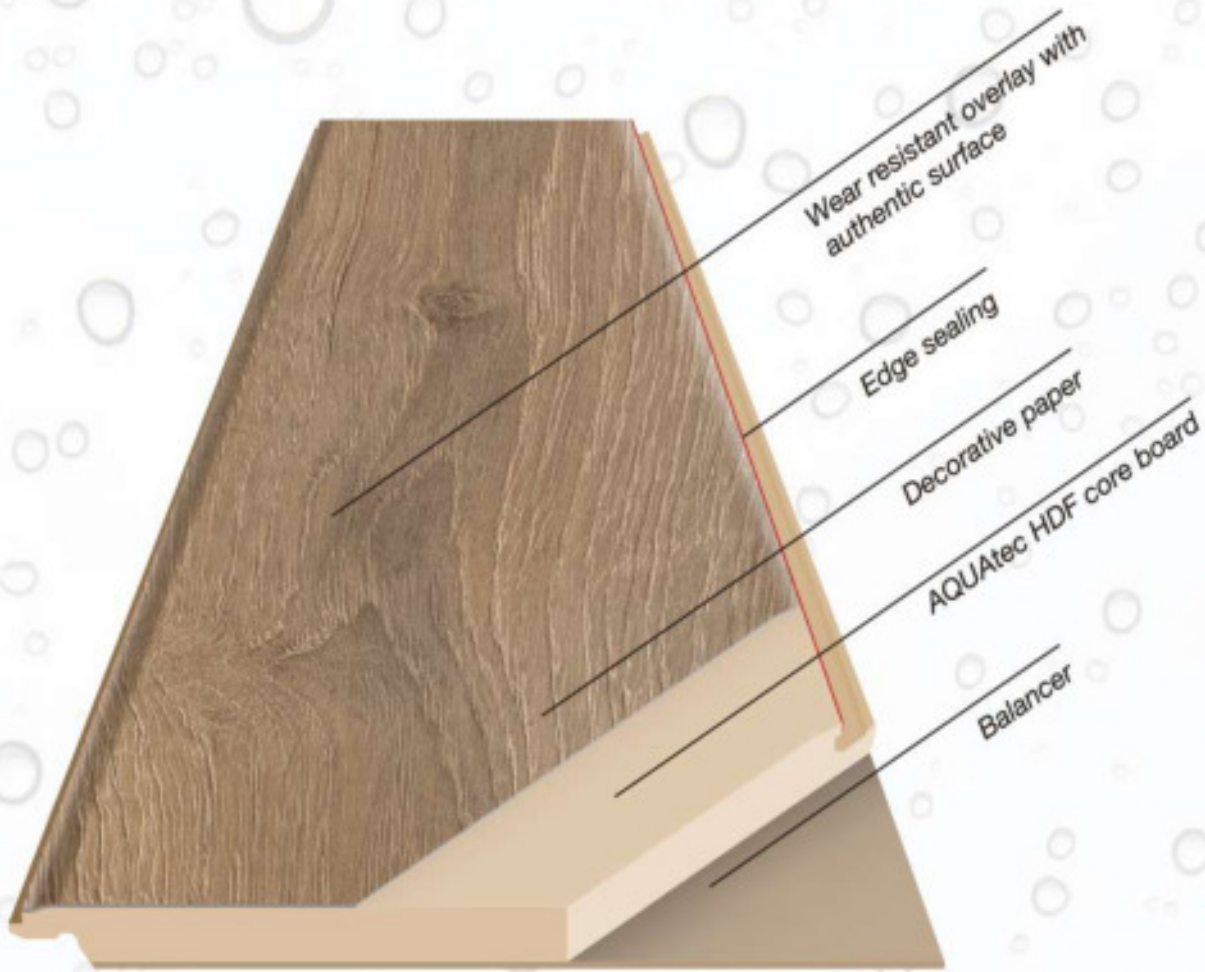

Sealed edges  
(Supreme 12mm)



Pressed Bevel  
(Supreme 12mm)



Sealed edges  
(Supreme 12mm)



Micro Bevel  
(Select 8mm)

\* See warranty details and installation instructions

Process self-locking, tight tongue & groove profile

1



2

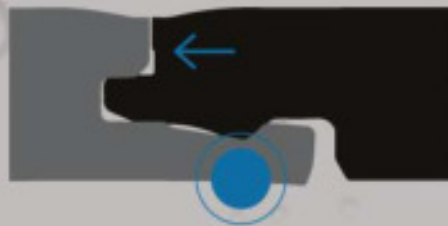

3



# SELECT



**4427** Pine MADERA BLANDA AV



**35991** Concrete FOSSIL AV



**K5574** Oak Evoke Knot SUNSET AV



**K4420** Oak EVOKE CLASSIC AV



**37843** Oak PALENA AV



**44406** Concrete Art WHITE AV

# AQUA PRO

Water resistant laminate flooring

- ✓ Protects against everyday spills for up to 24 hours! \*
- ✓ Easy to Maintain.
- ✓ Made in Europe.
- ✓ Scratch, dent and stain resistant.
- ✓ Authentic deep real hardwood texture with pressed bevel.
- ✓ Easy installation.
- ✓ AC4 wear rating.
- ✓ 8 mm & 12 mm thickness.

## Supreme Locking system (12 mm)

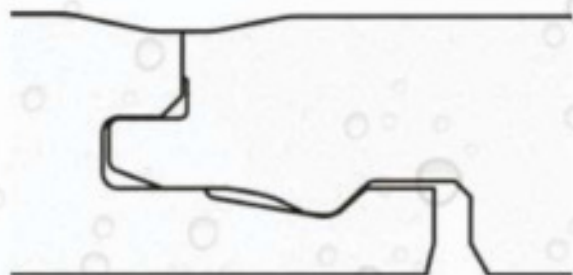

Compact Plank: 1287mm (50,67') x 192mm (7,56')

## Select Locking system (8 mm)



Standard Plank: 1383mm (54') x 193mm (7,6')



**HB** Historic Bevel Structure



**AV** Wire Brushed Structure

**35 YEARS**  
RESIDENTIAL WARRANTY

**5 YEARS**  
COMMERCIAL WARRANTY

**30 YEARS**  
RESIDENTIAL WARRANTY

**5 YEARS**  
COMMERCIAL WARRANTY

\* see warranty details and installation instructions

**AQUA**pro

Quality floors. Made in Salzburg.

